

INDUSTRIAL
COMMERCIAL
AGRICULTURAL
INSTITUTIONAL
MANUFACTURING

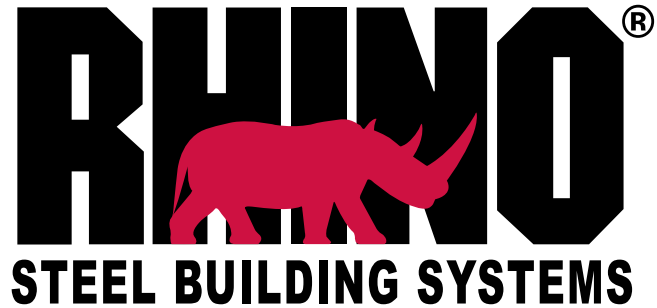

1 (888) 320-7466

RHINOBLDG.COM



TABLE OF CONTENTS

The Rhino Difference	2
Standard Product Features	3
Accessories.....	6
Insulation	7
Openings.....	9
Order Process	10

RHINO Steel Buildings are engineered to be:



STRONGER



**MORE
VERSATILE**



**EASIER TO
BUILD**

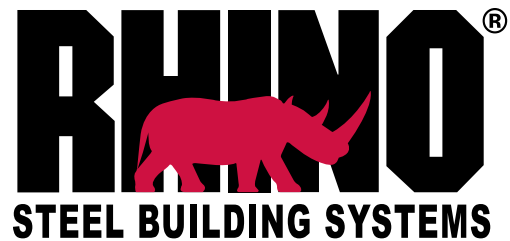

RHINO Steel Building Systems, Inc. is a premier provider of prefabricated steel buildings. From aircraft hangars and auto shops to riding arenas and restaurants, our buildings are versatile and customizable to meet all your needs. In fact, customers across varied climates all over the world, including the United States, Canada, and Mexico, all trust RHINO to provide strong, masterfully-designed buildings that will stand the test of time.



OVER 30% OF RHINO CUSTOMERS ARE REPEAT BUYERS OR REFERRALS. RHINO CONSISTENTLY HOLDS AN A+ RATING WITH THE BETTER BUSINESS BUREAU.

THE RHINO DIFFERENCE

What sets RHINO apart from other steel building suppliers? Our high-quality buildings, innovative features, and competitive pricing deliver the best value and greatest durability.

All standard RHINO prefabricated steel buildings provide these value-added benefits as part of The RHINO Difference:

- 100% commercial-grade steel framing
- Prefabricated framing components — with every piece cut to length, welded to shape, and drilled for simple bolt-together assembly
- Most clips welded to frames for easily attaching girts and purlins
- High-strength bolts and nuts for strong framing connections
- Steel building trim in your choice of colors
- A Bill of Lading that lists all parts shipped
- Three sets of Engineer-Stamped Plans, including a Letter of Certification and an anchor-bolt plan
- An Installation Manual
- A letter of certification which guarantees that the framing will meet or exceed code and loads designed for the lifetime of the structure



STANDARD PRODUCT FEATURES

RHINO buildings contain numerous features and benefits not commonly found elsewhere. These buildings offer a complete package of quality merchandise at competitive prices, providing many standard features that are often considered expensive add-ons at other businesses. RHINO buildings offer the best value in the industry by adhering to the highest standards in terms of durability, strength, weather resistance, and ease of construction.

Every RHINO building comes standard with the following features:

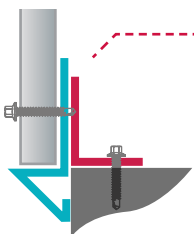

BASE TRIM

The base trim utilized at the bottom of the wall panels features a colored steel edge on which the wall panel rests. This provides two main benefits: first, this eliminates the need for a 1 ½” notch in the concrete around the perimeter of the slab, which can lead to rusting. Second, the base trim typically saves an average of 4 yards of concrete on a 5,000 sq. ft. building — an average of \$300 in savings!

**Base Trim Profile may vary.*

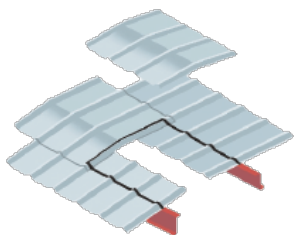

RHINO RIDGE CAPS*

RHINO’s die-formed ridge caps conform to all standard panel configurations, providing a much tighter seal at the roof seam. This creates metal-to-metal contact which increases moisture resistance and enhances pest control.

**In rare circumstances, dieform ridge caps do not apply.*

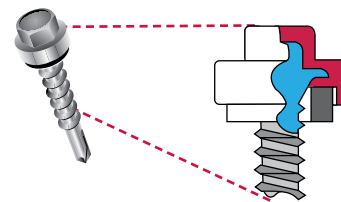

EXTENDED-LIFE SELF-DRILLING FASTENERS

RHINO utilizes long life fasteners for all sheathing in all standard building models. A long-term warranty ensures that no red rust forms, and an EPDM sealing washer creates a tight, waterproof seal that protects under the harshest conditions.

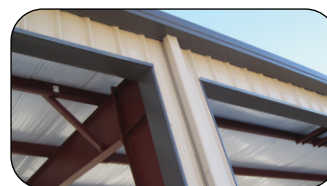

COVER TRIM

Cover trim is added to red iron framing on all overhead door openings. This enhances the appearance of the building by creating a more finished look, rather than leaving the framing exposed.

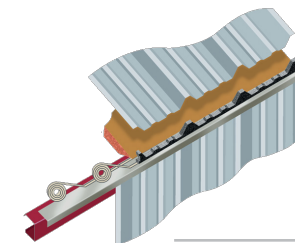

WEATHERPROOFING

Specially designed foam closure strips are utilized at the eaves, base, and roof to weatherproof all RHINO buildings. The mastic and double-sided tape for the closure strips are also included as part of the standard package.



ACCESSORIES

All RHINO buildings can be engineered to accept a wide variety of accessories for lighting, accessibility, ventilation, and insulation. Collateral loading can also be added to accommodate the weight of sprinkler systems, point loads, and other building elements. RHINO's range of accessories allows you to customize your building to suit your individual needs.

PURLIN BEARING RIB ROOF AND WALL PANELS

One of the advantages of choosing a RHINO building is the use of Purlin Bearing Rib (PBR) panels. PBR panels are superior to "R" panels, which are traditionally used in steel buildings. Compare the two panel types below to see why RHINO's PBR panels are the better choice.



Traditional "R" Roof Panel

These panel configurations have a shorter overlap and less metal-to-metal contact. RHINO's PBR Panels, on the other hand, have more overlap for greater water resistance and strength.



RHINO PBR Panels

RHINO standard PBR roof panels feature extra overlap for increased strength and water resistance. These affordable panels offer solid support and ease of installation. Roof panels are offered in standard Galvalume and are available in a variety of colors. Wall panels also include foam closure strips at all eaves and rakes in most cases. Contact a RHINO rep to discuss color options for your PBR wall panels.



SKYLIGHTS AND WALL LIGHTS

Reinforced skylights are available in standard lengths and can be ordered to meet UL 90 rated roof systems. These translucent panels have the same profile as metal panels for seamless integration. Wall lights for sidewall installation are also available.

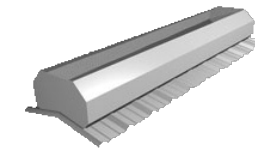

VENTILATION

RHINO offers two types of vents for controlling air flow in your building. Standard louvered vents can be installed in the endwalls and are constructed from AZ55 Galvalume. Standard roof ventilators feature bird screens and come in a variety of size and material options.



LINER PANELS AND PARTITIONS

RHINO can provide paneling for the interior walls and ceiling of your building. Liner panels can cover all interior walls and the ceiling, or just half the wall height. In addition, partitions of any size can be ordered, which is ideal for manufacturing and institutional buildings.

For superior performance with long-term energy savings, the **Pro-Value Insulation System** is the best choice. The higher initial investment is quickly recovered in a short time — in fact, the Pro-Value Insulation System has been known to cut energy bills by as much as 50%. Features include:

- Superior “in-place” R-values for both roof and wall cavities
- Savings on energy costs, and HVAC and lighting utility investments
- Vapor barrier prevents condensation and brightens interiors
- Superior sound absorption
- Lower maintenance and longer life of the building

PRO VALUE ROOF SYSTEM

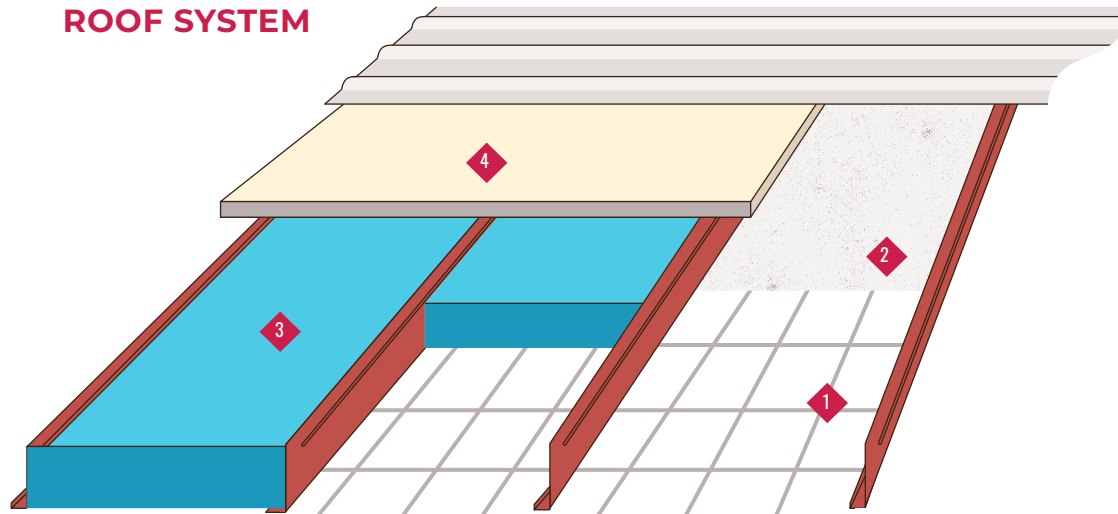

1 STEEL RETAINER STRAPS

The first step in a RHINO Pro-Value roof system is the installation of straps that hold the fabric and insulation in place.

2 VAPOR BARRIER FABRIC

The extra strong and durable barrier helps eliminate condensation and roof deterioration. It encapsulates the purlins and girts for a more finished, professional interior and is available in white or designer colors. Factory-made double extrusion welded seams preserve the low vapor permeance and vapor barrier integrity. RHINO Pro-Value liner fabric is over 300% stronger than competitive metal building facing (VRP).

3 FULL THICKNESS INSULATION

Insulation material fills the purlin without compressing the material, providing superior “in-place” R-values and as much as 50% lower energy costs throughout the year.

4 SECOND LAYER OF INSULATION OR THERMAL BREAK

A second layer provides additional R-value, plus a critical thermal break between purlin and metal sheeting. When this is not used, clip-on thermal breaks can be provided.

PRO VALUE WALL SYSTEM

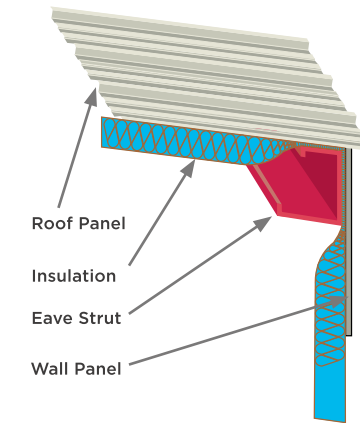
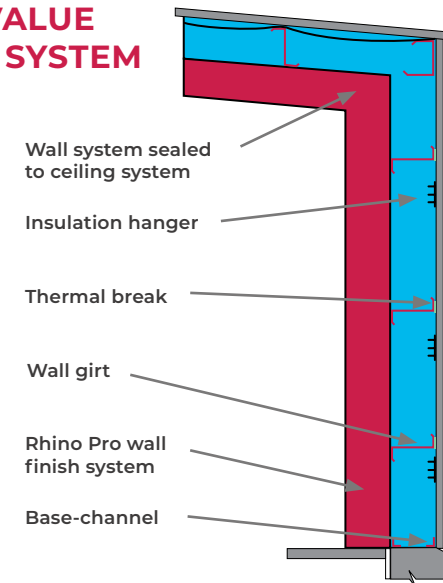

STANDARD INSULATION

RHINO offers standard building insulation that is easily installed and provides big savings in energy costs. The standard option is fiberglass insulation that ranges from 3” to 6” thick. This insulation option has reinforced backing and is installed with a standard closure strip and mastic, protecting the building from harsh weather conditions.



OPENINGS

FRAMED OPENINGS

RHINO's framed openings can be engineered to accommodate virtually any size door, such as large bi-fold doors for aircraft hangars. Framed openings can be added to your building at the factory location of your choosing to save time and labor in the building erection process.

OVERHEAD DOORS*

Sectional overhead doors are available with optional chain hoists and electric operators. All doors have the option of being insulated and wind-certified up to 145 mph. Overhead doors come in standard white or brown colors, with the option to powder coat the doors in any custom color. Order your framed opening to coincide with the appropriate door size.

**Drum doors are available, some restrictions apply*

PERSONNEL DOORS

Walk doors are available in 3070, 4070, and 6070. All doors come standard with the lock and key, steel frame, and threshold. Some additional options include insulated leaves, closers, panic hardware, half-glass, narrow lite, special wind ratings, dead bolts, and mortise locks.



ORDER PROCESS

Typical delivery time is six to eight weeks but can vary due to market conditions and building complexity. All Production Orders have price protection against any steel price increases as long as building is not delayed by the customer.

1

SUBMIT QUOTE

Tell us your preferred building size, the project location, and what accessories you need. We'll then send you an order form.

2

APPROVE

Approve the order form, confirm building loads and codes; return to Rhino.

3

CERTIFICATIONS SENT

You will receive your letter of certification and three sets of engineered stamped prints.*

4

RECEIVE MANUAL

You receive a confirmation letter from Rhino with the Erection Manual. We'll also give you a tentative delivery date and time.

5

CUSTOMER SUPPORT CALL

A Rhino customer support rep gives you a call confirming date and time of delivery. This is the perfect time to ask any questions.

6

YOUR RHINO STEEL BUILDING ARRIVES!

*Delivery timeframe may vary due to the complexity of the project. Ask your sales representative for updated drawing times.



CUSTOMER SUPPORT

At RHINO, we believe that providing superior customer support is what separates us from the competition. Since 1998, we have consistently provided outstanding after-the-sale support and service with our in-house customer service department. Our dedicated team is just a phone call away and will answer any questions you may have regarding the sales process, delivery, or construction. As a testament to this fact, over 30% of our orders come from referrals or repeat purchases from past customers.



1 (888) 320-7466

RHINOBLDG.COM

4305 I-35 NORTH,
DENTON, TX 76207

P (940) 383-9566
INFO@RHINOBLDG.COM

